



NASSAU COUNTY BOARD OF COUNTY COMMISSIONERS

DEPARTMENT OF PUBLIC SAFETY

911 COORDINATOR
50 Bobby Moore Circle
P. O. Box 596
Yulee, Florida 32041



Resolution Number 97-113

WHEREAS, the Board of County Commissioners of Nassau County, Florida did establish Ordinance Number 92-14 providing for a process of naming and renaming streets in Nassau County, and

WHEREAS, the majority of citizens of Nassau County currently residing on "unnamed easement located east off North Kings Road"; located in Section 6 & 50; Township 2N; Range 25E; have requested the street be named "Bourdeau Lane"; and

WHEREAS, the 911 Coordinator's office has reviewed the request in accordance with Ordinance Number 92-14, and has verified the request as acceptable and not in conflict with names already assigned, and

WHEREAS, the 911 Coordinator's office has forwarded the request to the Board of County Commissioners for consideration, now

THEREFORE, LET IT BE RESOLVED; this 21st day of April 19 97, that the street currently known as unnamed easement located east off North Kings Road in Nassau County, Florida be hereafter referred to and known as Bourdeau Lane in Nassau County, Florida, and the County Engineer shall be authorized to erect any and all necessary signs indicating said name.

BOARD OF COUNTY COMMISSIONERS
OF NASSAU COUNTY FLORIDA

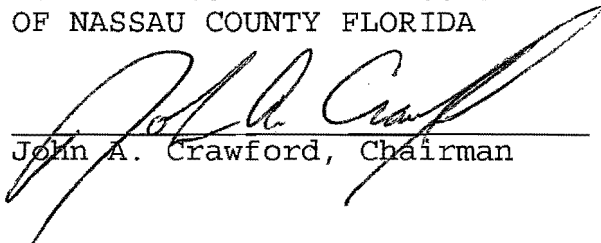
John A. Crawford, Chairman

ATTEST:

J. M. "Chip" Oxley, Jr
Ex-Officio Clerk

2/13/97

Linda Cox
911 Coordinator
P.O. BOX 596
Yulee Florida 32097

Dear Linda Cox

I am requesting that the unnamed easement on my property under the name of Bourdeau Bros Real Estate Formally known as Schuman Dairy Road be changed to Bourdeau Lane. The easement is the next road after the Land Fill in Callahan heading North on us 1 toward Hilliard. I have spoken to John Purvis for this address, Thank you and we will be in touch with the office in Callahan on your decision as we don't have an address yet in Callahan from your office.

Sign
Herman Bourdeau, President
Bourdeau Bros Real Estate

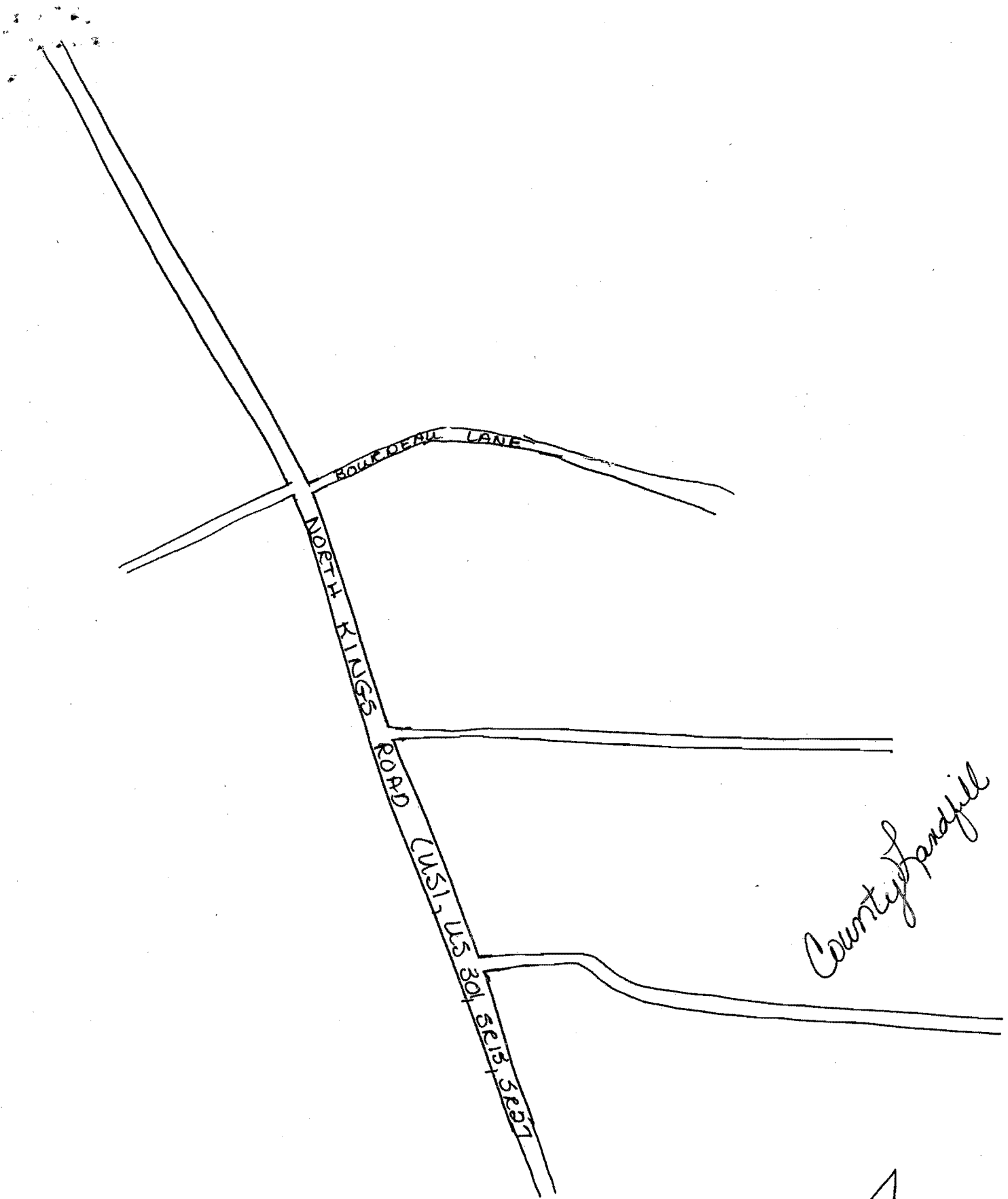

06 20 25E
 + 50 20 25E



30/N